

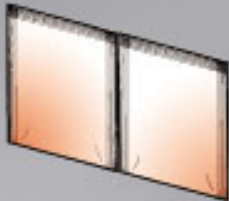

ROVEMA

Vertical Intermittent Motion V VI-2 Pouch Machine

...for the production of high quality 3 sided, 4 sided,
and "doyle style" stand-up pouches

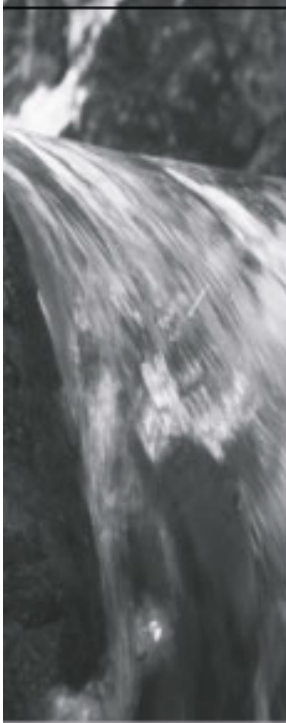

...innovative, economic, flexible , and highest quality

Advantages

- automatic format changes with the push of a button
- flexible format range, without format size changes - pouch widths from 50 -200mm ($1\frac{31}{32}'' - 7\frac{7}{8}''$) and pouch heights from 80-250mm ($3\frac{5}{32}'' - 9\frac{5}{16}''$)
- compact design - the footprint of the VVI is considerably less than that of a horizontal machine
- speeds up to 100 pouches per minute on a single machine
- minimal downtime during product changes
- highes quality pouches due to its optimized design
- reduced packaging costs are achieved by utilizing thinner heatsealable film structures (20 - 120 um)
- highest quality manufacturing for decades of production and low maintenance requirements



ROVEMA

ROVEMA
Packaging Machines L.P.
650 Hurricane Shoals
Road NW, Lawrenceville,
GA 30045 USA
Tel: +1-770-513-9604
Fax: +1-770-513-0814
Email: sales@rovema.com
http://www.rovema.com

ROVEMA
Verpackungsmaschinen GmbH
Industriestrasse 1
D 35463 Fernwald
Tel: ++49-641-409-0
Fax: ++49-641-409-212
Email: info@rovema.de
http://www.rovema.de

ROVEMA
Endverpackungstechnik GmbH
Industriestrasse 1
D35463 Fernwald
Tel: ++49-641-409-0
Fax: ++49-641-409-212
Email: info@rovema.de
http://www.rovema.de

ROVEMA
Verpackungsmaschinen Sp. Zo.o.
ul. Odyńca 51
PL-02-606 Warszawa
Tel: ++48-22 844 7748
Fax: ++48-22 854 0446
Email: postmaster@rovema.atomnet.pl

Rovema Iberica S.A.
C/Mas d'en Cisa, 5.
Apdo. Correos No 55
E 08181 Sentmenat (Barcelona)
Tel: ++34-93-7 15 46 00
Fax: ++34-93-7 15 46 38
Email: rovema@rovema.es

ROVEMA
Packaging Machines Limited
9A Alton House Office Part
Gatehouse Way, Aylesbury
Bucks HP 19 3U
United Kingdom
Tel: ++44-12 96-48 32 36
Fax: ++44-12 96-48 73 04
Email: sales@rovema.co.uk

ROVEMA Benelux by
Everdenberg 9, 4902 TT
Postbus 4357, 4900 C
NL Oosterhut
Tel: ++31-162-576 464
Fax: ++31-162-576 465
Email: Sales@rovema.nl

ROVEMA Italia s.r.l.
Viale P.O. Vigliani, 21
I 20148 Milano
Tel: ++39-02 48 01 17 85
Fax: ++39-02 48 00 82 59
Email: rit@rovema-italia.it

ROVEMA
Verpackungsmaschinen Ges.m.b.H.
Linzerstr. 113/38
A 1140 Wien
Tel: ++43-22 36-4 64 85
Fax: ++43-22 36-4 64 53
Email: rovema@EUNET.at

ROVEMA Asia
60 Albert Street 09-05
Albert Complex
1899 69 Singapore
Tel: ++65-339 01 26
Fax: ++65-339 22 09
Email: infor@rovema.com.sg

...and over
60 representatives
worldwide

The principle

Product enters the system through the forming tube.

The forming collar shapes the flat film into a round film tube.

Low friction rollers guide the film to the forming area.

Vertical sealing bars seal the edges of the film tube together.

Film transport belts pull the film through the forming area.

Cross sealing jaws create top and bottom seals in the pouches.

With the latest design VVI - the vertical intermittent running side sealing machine - ROVEMA has further developed the scope of vertical form, fill, and seal machinery.

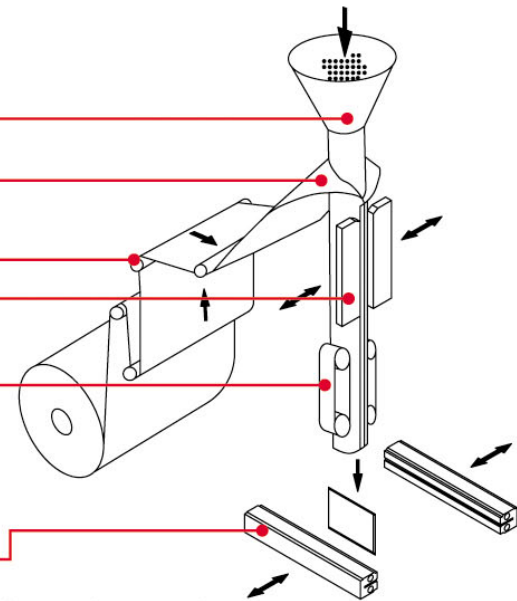

Features

The VVI-200 system, with 10 patents, combines the traditional applications of a horizontal machine as well as the advantages offered by vertical form, fill, and seal equipment.

The enclosed system allows for the dust-free packaging of products as well as for the optional gas flushing with a residual oxygen content of < 1%.

The standard vacuum assisted draw down belts, ensures a good material transport with films thicker than 20um. Therefore, the machine can handle thin film structures with ease.

Programmable sealing times and the patented, wear-free cross sealing jaws with a sealing pressure of up to 5000N provides the highest pouch quality.

The automatic format change by a button enables the effective production of different pouch dimensions without any tooling requirements. Down time during product changeover is minimized, dosing screws can be removed for cleaning without dismantling the forming set.

With a space requirement of approximately 17 ft² and a height of approximately 5ft, the possibility of adding splicing units, printers, labelers, zipper applicators, etc. is possible without adding excessive footprint to the machine.

The VVI-200 performs with a speed of up to 100 pouches per minute on a single execution. Additionally, two baggers can be set in place, while maintaining original system controls, for higher productivity.

The VVI-200 comes with standard Allen-Bradley Controllogix.

Technical details may be subject to alterations.

The illustrations in this leaflet partly show special executions.



Integrated systems

©2003 by Rovema