

ROVEMA Program

Overview product portfolio



DOSING
SYSTEMS



FORM FILL AND
SEAL MACHINES



CARTONING
MACHINES



FINAL PACKAGING
MACHINES



PACKAGING
LINES

 **ROVEMA**

Sustainable packaging solutions

Resource-efficient packaging



Find out more

www.rovema.com/en/company/sustainability

ROVEMA packaging systems offer manufacturers and producers various approaches to save resources:

For ROVEMA, responsible development means using existing resources carefully and in an environmentally friendly way. Our products and systems become economically sustainable through the use of innovative technologies that enable the processing of regrowing, renewable and recyclable packaging materials. This also includes the reduction of energy consumption and the optimization of packaging volumes. With an optimized design for the transport packaging, the CO₂ emissions are reduced on route.

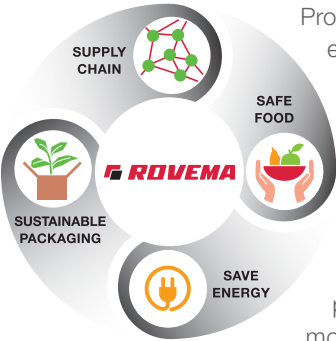

Product quality must be protected especially for perishables and baby foods, durability and safety is our number one priority. Products cannot be stored optimally refrigerated and protected from light everywhere. Maintaining high product quality after production, combined with modern and efficient packaging processes, can drastically reduce product losses and thus conserve packaging resources.

For ROVEMA, acting in line with the times means taking responsibility for people and the environment.

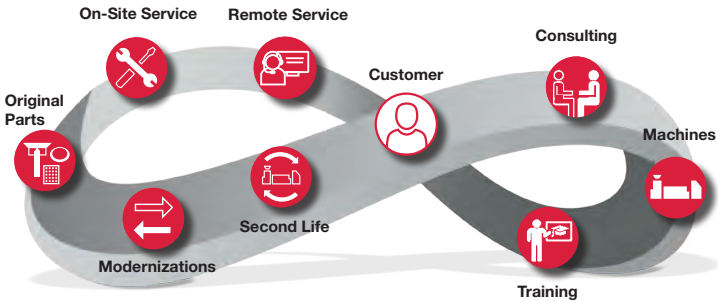

With our global network, we are on site for you and will support you throughout the entire machine life. In this context, we offer a wide range of retrofitting and conversion options for existing machines, enabling them to be converted to meet new requirements, such as paper packaging materials.

With **ROVEMA Second Life**, used machines become fit for new packaging tasks. ROVEMA takes back used machines, overhauls them and makes them available to new buyers..

Dosing systems

Precise, protective of the product, hygienic



Find out more

www.rovema.com/en/packaging-machines/dosing-systems



Dose products individually and with high accuracy.

Sophisticated metering systems consistently matched to the product ensure efficient filling.

The right dosing system for your application

- **Volume dosing VDD:** Designed for lumpy and granulated free-flowing products such as rice, short cut pasta, peanuts, pulses, chocolate, lentils or sugar.
- **Auger dosing SDH** in hygienic design. Almost all powdery and fine-grained products such as powdered milk, coffee, spices, sugar and chemicals can be processed.



Block Pack System SBS

Maximum flexibility in bag design

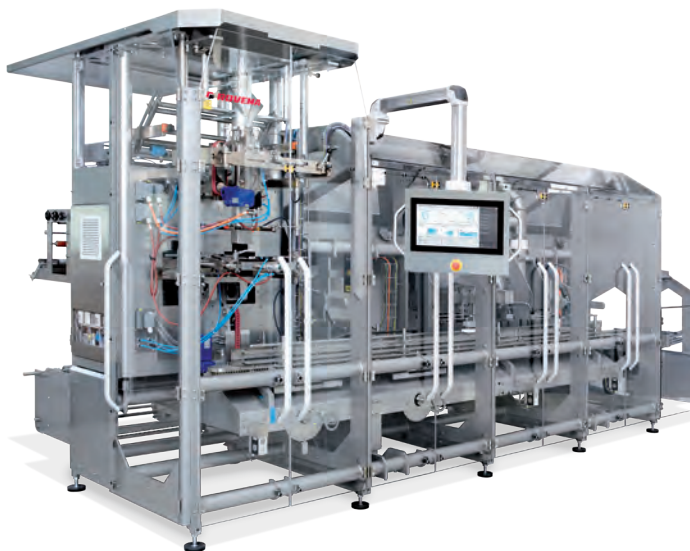

Integrated system of Form Fill and Seal machine and downstream modules for bag top and bag closure design.

Available as single or twin variant. Future-proof system due to modular design.

For fragile products: Empty bag creation and filling with low drop height. Different bag top shapes and re-closure options are possible for a single machine.

Option for stackable products: Oriented feeding and product-friendly stacking, e.g. of baked goods and coffee pods.

Find out more

www.rovema.com/en/packaging-machines/form-fill-and-seal-machines



Bag top shapes

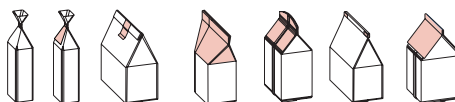
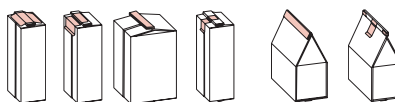
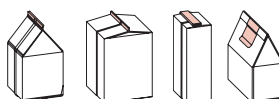

Form Fill and Seal machines

Efficient packaging at the highest level



ROVEMA Form Fill and Seal machines pack your product reliably and with the highest output rate into flexible pouches. Continuous or intermittent forming, filling and sealing in one operation.

The multi-talents for flexible changeover between packaged goods and bag shapes:

- ▶ **BVC 180/260/400:** For maximum output with perfect bag quality
- ▶ **BVC 260/400 Flexible:** Pillow bags, Stabilo Seal and Doypack-like stand-up pouches with zip (RoPack) on one machine
- ▶ **BVI 180/260/400:** Flexible and economical with intermittent operation
- ▶ **BVK 260:** For standard bag shapes such as flat bags and block bottom bags

The industry specialists:

- ▶ **BVC 165 TwinTube:** Compact twin-tube Form Fill and Seal machine for high-speed applications in the confectionery and snack sector
- ▶ **BVC 310 Liquid:** Industry machine for the food service sector, specializing in flexible packaging of homogeneous liquids and 2-component filling, e.g. cucumbers in brine
- ▶ **BVC 400 Frozen:** Vertical Form Fill and Seal machine for frozen foods
- ▶ **BVC 250 Compact:** The high-performance machine for rooms with low ceilings
- ▶ **BVC 250 Candy:** The compact high-speed machine for confectionery and snacks
- ▶ **BVC 310 Fresh:** Compact packaging solution for fresh produce

Examples of possible bag shapes

Pillow bags

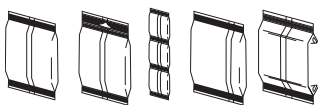

Sealed edge bags

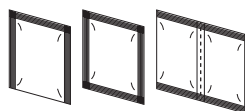

Stand up pouches:

Block bottom pouches

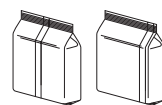

Stabilo Seal



RoPack bags

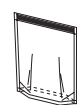

SUP

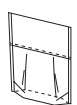

Reclosable bags

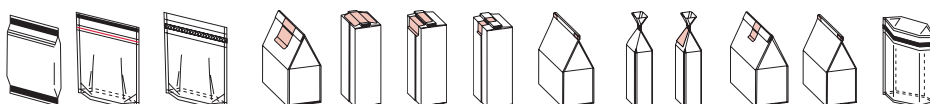

New bag shapes



Cartoning machines

Cartoning vertically or horizontally



Find out more

[www.rovema.com/en/
packaging-machines/
cartoning-machines](http://www.rovema.com/en/packaging-machines/cartoning-machines)



Robust cartoning machines for erecting and filling folding boxes. Reliable processing of demanding blanks and folding carton materials, as well as by air erection. Adapted feeding systems for your application.

Vertical filling of folding boxes:

- ▶ Vertical direct filling with unpacked products
- ▶ Vertical filling of folding boxes with packaged products
- ▶ Vertical bag-in-box solutions with one to two Form Fill and Seal machines, filling level up to 95%.
- ▶ Vertical ROVEMA cartoning machines allow the integration of different dosing systems

Horizontal filling of folding boxes:

- ▶ Bag-in-box packaging, also with spoon or brochure insert
- ▶ Wide range of deposit and stacking patterns due to flexible transfer systems
- ▶ Flowpacks, trays or other articles in folding boxes

Picker EPU

Completely integrated solution to enclose packaged dosing spoons and other accessories.



Product-in-Box



Bag-in-Box



Final packaging machines

Packaging with dual use



Find out more

www.rovema.com/en/packaging-machines/final-packaging-machines



Many transport or collective packages are also sales packages. They must be attractive and of high quality, but at the same time robust and easy to handle. This calls for systems that cover a wide variety of packaging types and also make unusual packaging shapes feasible.

- ▶ Machines for erecting, filling and closing carton blanks (AC cartons) and flat blanks
- ▶ Box erectors and closers
- ▶ Filling systems for trays and AC cartons

American Case (FEFCO 0201 / 0200)

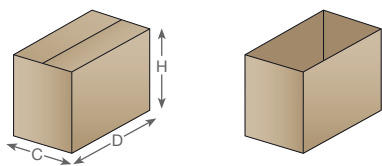

Wraparound

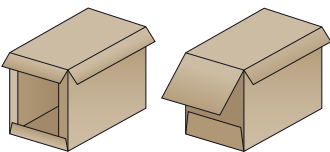

Open trays

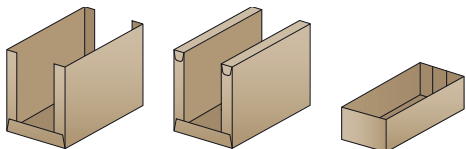

Trays with lid (inside or outside)

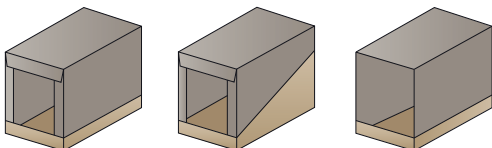

Boxes

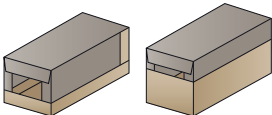
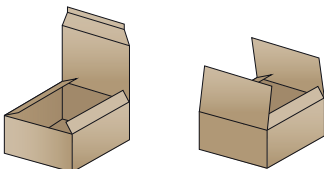

Automated packaging lines

Perfectly synchronized packaging systems
from a single source



ROVEMA offers individual packaging systems for every phase of the filling and packaging process.

Find out more

[www.rovema.com/en/
packaging-machines/
packaging-lines](http://www.rovema.com/en/packaging-machines/packaging-lines)



ROVEMA offers a wide range of products for the packing industry:

- ▶ **Dosing systems** with volumetric, gravimetric and combined operating principles
- ▶ **Vertical Form Fill and Seal machines** with intermittent and continuous mode of operation
- ▶ **Block packing machines**, i.e. combined bag filling and sealing machines
- ▶ **Cartoning machines**, vertical and horizontal
- ▶ **Final packaging machines**
- ▶ **Packaging lines and systems** that integrate the above-mentioned machines or technologies into turnkey systems

While individual packaging machines can still be installed with little planning effort, important criteria regarding layout, interfaces, operability, product flow and packaging material logistics must be taken into account for complex packaging lines. Here, specialists are required who guarantee the user the greatest possible benefit and minimize investment risks. ROVEMA plans for you in existing production units or for complete new buildings.

Flexibility that gives you the edge

ROVEMA integrates customer's own systems and aggregates of external suppliers on request. Before delivery, all systems are completely assembled and commissioned and can thus be accepted by our customers with maximum installation safety. Modern machine controls like ROVEMA P@ck-Control or Rockwell allow a complete system synchronization.

ROVEMA advantages at a glance:

- ▶ One contact for the entire turnkey project
- ▶ Worldwide regional contacts for best maintenance of machine availability
- ▶ Simulations and test runs with original product and different packaging materials for various packaging forms in ROVEMA's own test and trial center
- ▶ High production capacity thanks to coordinated functional units (printers, conveyor belts, drives, etc.)
- ▶ High efficiency and maximum availability through use of components from leading system suppliers
- ▶ Reliable commissioning, as each system is tested with original product and packaging material at ROVEMA before delivery
- ▶ Connection of a customer's MES system can be tested together with the customer on ROVEMA's premises during commissioning
- ▶ Consistent hardware, control and HMI structure

ROVEMA worldwide

Our Global Network



ROVEMA Subsidiaries

ROVEMA France SAS
93360 Neuilly-Plaisance
info@rovema.fr

ROVEMA Benelux bv
4906 AC Oosterhout
sales@rovema.nl

ROVEMA Italia s.r.l.
20026 Novate Milanese (MI)
info@rovema-italia.it

ROVEMA Packaging Machines Ltd.
Gatehouse Close/Aylesbury
sales@rovema.co.uk

ROVEMA Spain and Portugal S.L.
08208 Sabadell/Barcelona
rovema@rovema.es

ROVEMA Makine San. Ve Tic. A.S.
34870 Kartal/Istanbul
info@rovema.com.tr

ROVEMA Polska Sp. z o.o.
02-672 Warszawa
rovema@rovema.pl

ROVEMA North America Inc.
Norcross, GA 30093
info@rovema-na.com

ROVEMA Latinoamérica S.A.
Panama City
rlainfo@rovema.com

ROVEMA Asia Pacific
Corporation
Makati City/Philippines
info@rovema.com.ph

ROVEMA Headquarter

ROVEMA GmbH
Industriestrasse 1
35463 Fernwald, Germany
Phone: +49 (0)641/409-0
info@rovema.de
www.rovema.com

Affiliates

DL Packaging
www.dlpack.com

ROVEMA India Pvt Ltd.
www.rovemaindia.in



Sales partners and service centers worldwide

www.rovema.com